

Wall Mount Instructions

Williams Racing FW14B – (10353)

Kit Contents:

- A. 1x Left Arm
- B. 1x Right Arm
- C. 1x Back plate
- D. 1x Front plate
- E. 1x Info card mount
- F. 2x Wall Screw
- G. 2x Wall Plug
- H. 3M Command Strip

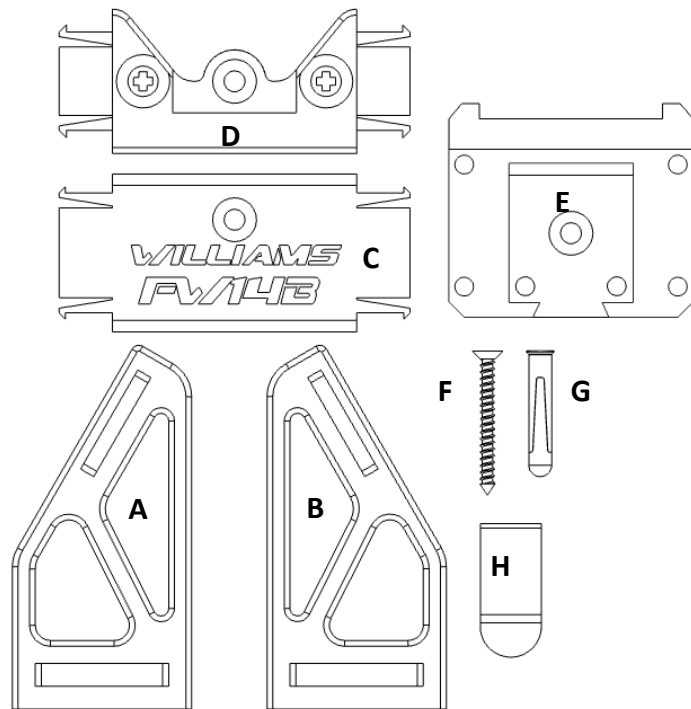

Angled Mount

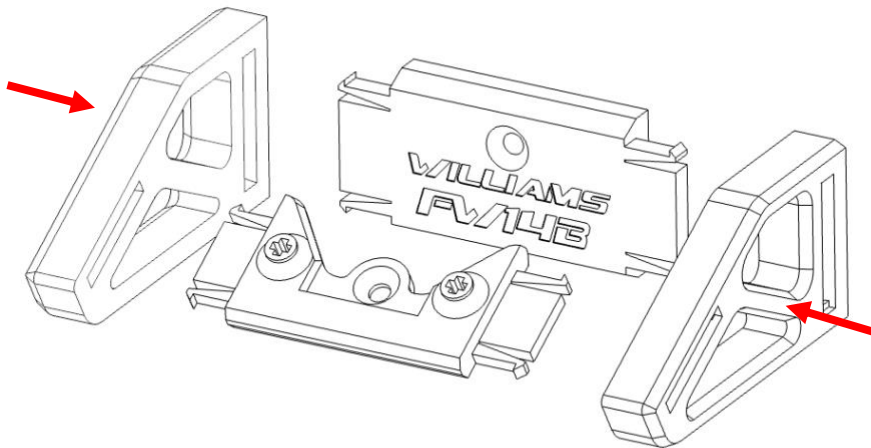

Do not over tighten the wall screw

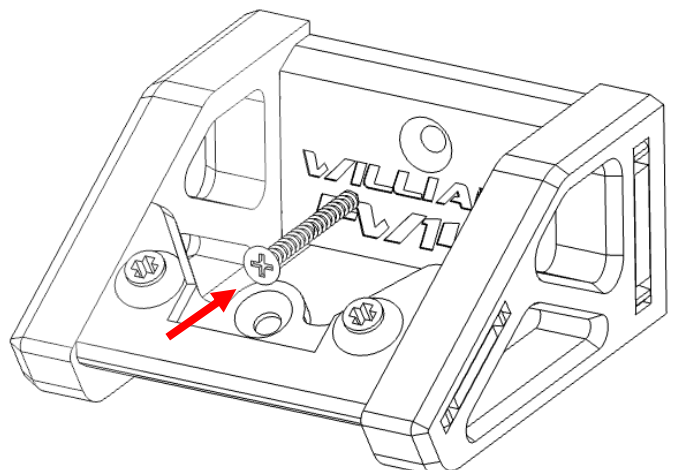

Wall Mount Instructions

Williams Racing FW14B – (10353)

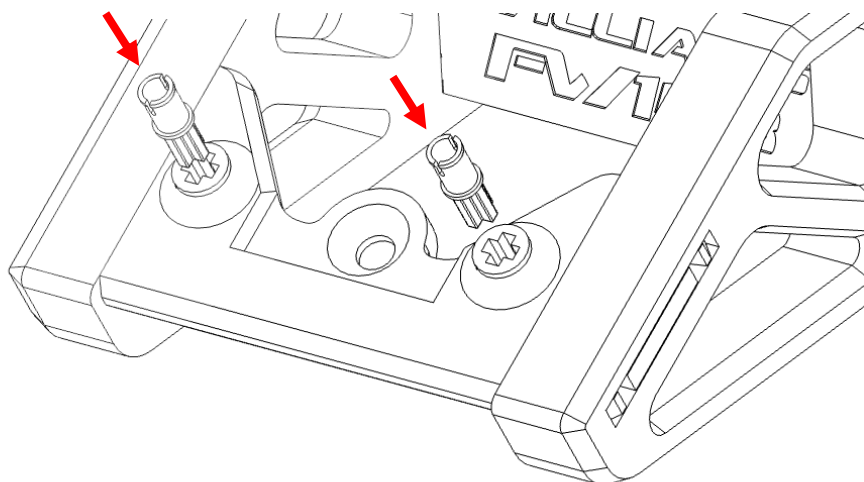

Use the two blue pins from the original Lego set display mount

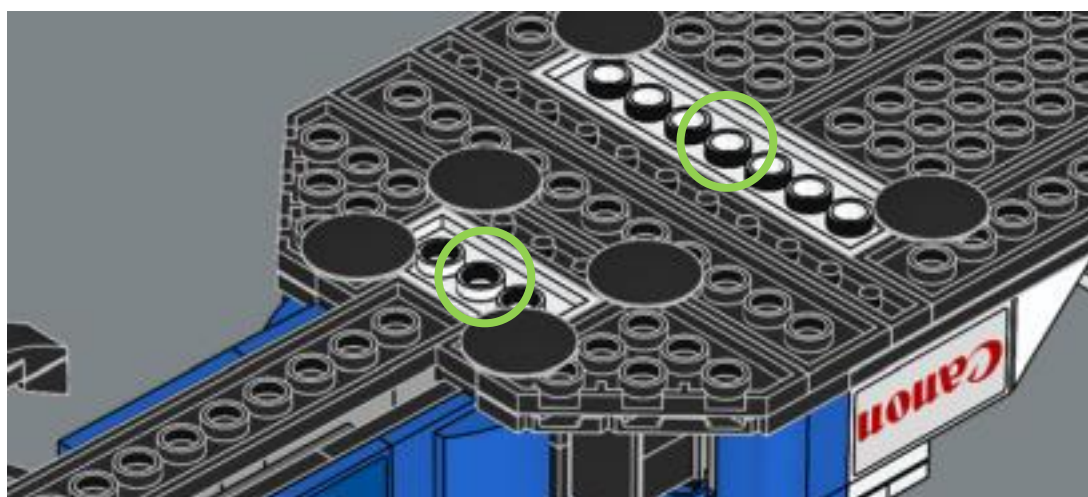
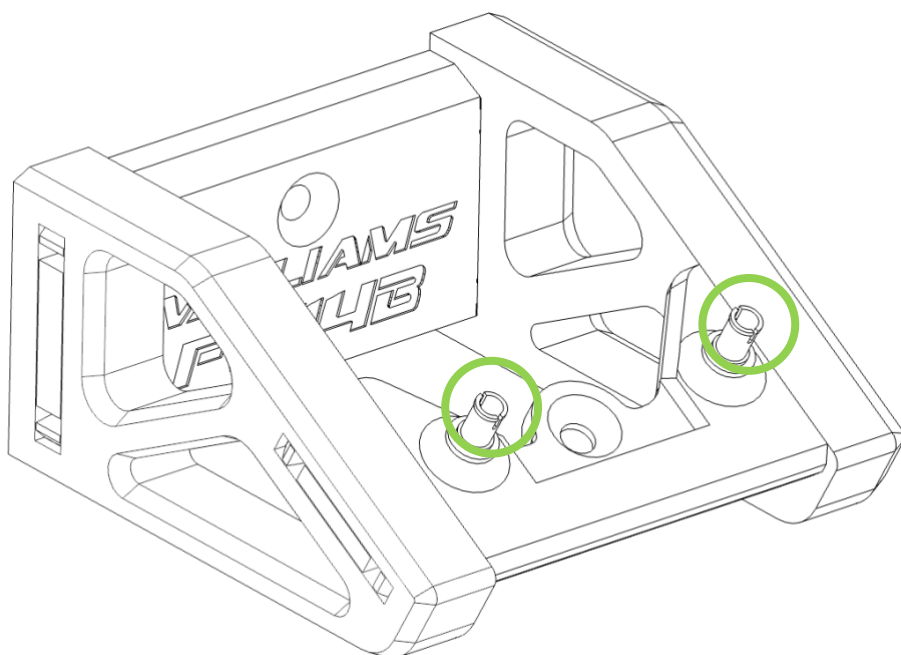

Wall Mount Instructions Williams Racing FW14B – (10353)

Flush Mount

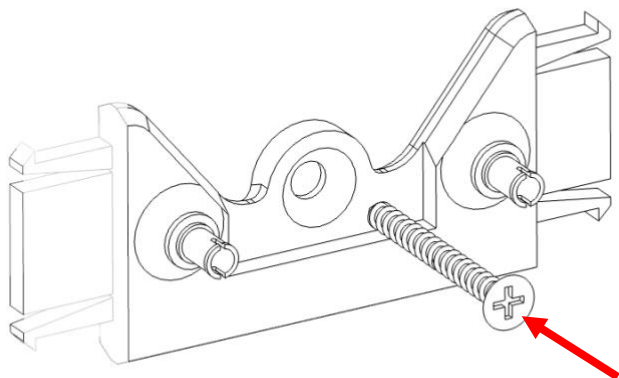

Use just the front plate as a flush wall mount. You can orient the plate in any direction to suit your preferred display orientation

Info Card Mount

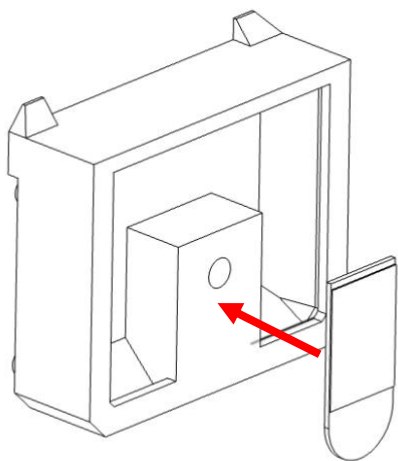

Seat the Info card here

Seat the podium here

